

The Grand 1894 Opera House  
Galveston Island, Texas

**Technical Package**

Updated – September 2007

This compilation has been created to fulfill all requests for technical information from production companies and or renters who seek technical and structural details needed to advance plan events. Our intention in this creation is to anticipate the standard of information contained in the majority of production questionnaires presented to The Grand. In the event, the information you require is not contained within this compilation. Direct all technical and structural questions to:

*Jeffery M. Pye*

*Stage Manager*

*Technical Director*

*IATSE #51*

Business (409) 763-7173 ext.111

Cell (409) 771-3822

Fax (409) 766-1546

Home (409) 744-7481

Email: [jpye@thegrand.com](mailto:jpye@thegrand.com)

The Grand 1894 Opera House  
2020 Postoffice Street  
Galveston, Texas 77550  
Website: [www.thegrand.com](http://www.thegrand.com)

Maureen M. Patton

Executive Director

Email: [mpatton@thegrand.com](mailto:mpatton@thegrand.com)

## General Information

Business Office Phone	Box Office Phone	Production Office Phones
409-763-7173	409-765-1894	409-766-1546
409-763-1068 (office fax only)	800-821-1894	409-763-1862

The Grand has wireless Internet access available for traveling production personnel.

### Directions to The Grand:

Interstate 45 South from Houston to Galveston Island. Interstate becomes Broadway. Continue on Broadway to 21<sup>st</sup> Street. At the traffic light turn left. Continue 5 blocks to Postoffice street. Turn right to find The Grand on left hand side. Continue 2/3 down the block to find double door loading dock.

### Parking Policy:

Tractor trailers may park at the dock. Overflow on Postoffice St. Crew and cast buses may park, with the engines off, at the barricaded area on north side of street **ONLY**. Shore power hook up is available. Trailers may stay at the dock for the run of the show but tractors must be unhooked and parking of the tractors are the responsibility of the transportation/production company. Overflow trailers will be accommodated. South side of Postoffice street parking is prohibited due to The Galveston Transit System Trolley traffic. **You will be towed at your own expense.** The Grand loading dock is patrolled by a local towing company; therefore, any and all personally owned vehicles are subject to towing at owner's expense, unless proper authorization and necessary permits are obtained.

(See Jeffery M. Pye, **ONLY**, for authorization and permits)

Parking permits must be returned at the end of the run without fail.

Garbage dumpster must not be blocked under any circumstances.

There are circumstances when The Grand can and will accommodate any scenario, as long as we have enough advance notice to make the necessary arrangements.

### Truck Loading:

Entrance from Postoffice Street

Room for 2 Tractor-trailers at 2 loading dock doors

Loading dock is 50" off the ground. Doors are 8'5" wide x 9' tall

Ramp up 15° incline to work/storage area (19'w x 27'l x 22'h)

90° left turn to stage entrance (5'11"w x 10'h)

### Labor:

All labor is provided by The International Alliance of Theatrical Stage Employees

Stage: IATSE, Local #51 Houston/Galveston Chartered May 1899

Wardrobe: IATSE, TWU #896 Houston/Galveston Chartered January 1979

All labor arrangements must be made through Technical Director. No exceptions.

# The Grand 1894 Opera House

## General Information

### Stage Dimensions:

Proscenium Opening – 38'w x 27'h

Plaster Line to back wall – 36'

Plaster Line to furthest upstage line set – 32'

Plaster Line to lip of stage (thrust) – 4' @ center / 1' SL and SR

Grid Height – 59'

Stage Playing Area – 40'w x 32'd

Wing Space – 16'w x 36'd SL / 16'w x 36'd SR (obstructed by switch gear 2' x 5')

SL Wall to SR Wall – 72'

Upstage crossover – 4'

**Note: Over each wing, beginning 2' from proscenium, there is a working platform that extends to the side walls and from the proscenium to the back wall. This working platform is 22'6" from stage deck. This means that the maximum width of all flying pieces is 42'. These platforms are the fly floor on stage left and the dimmer room on stage right. The platforms are joined together by a cat walk, 22'6" from stage deck 32' from plaster line and is 4' wide.**

### Orchestra Pit:

The Grand is equipped with a mechanical spiral drive orchestra pit. The pit has 100% variable stopping points. Maximum depth level of the pit is 7'1-1/2". The dimensions of the pit are 8'd@ center, 2'd SL and SR. Overall width is 38' extending from proscenium left to proscenium right. The pit can be seated with 32 seats.

### Lifts / Ladders / Scaffolding:

JLG AM-24-DC "Access Master" 24' battery powered man lift (maximum reach height 30' average)

24' A-Frame ladder (on wheels)

Various height stepladders

Aluminum scaffold 7'deck with 7' extensions (14' maximum deck height)

### Fly System:

Hemp (Multi-line II 3 strand twisted polyester) integrated with double purchase counter weights. See attached rigging schedule for details.

### Dance Floor:

The Grand has a 40'w x 32'd Rosco dance floor (Marley)

### Rehearsal Room:

40'w x 32'd. This room is above backstage storage/shop area and is also designated Dressing Room #6.

### Production Office:

Under stage – For use by Production/Company Managers. Phone # 409-763-1862

### Notes:

Because console operators will be in full view of patronage. We require the technician to wear appropriate attire. Absolutely no sleeveless shirts, shorts or hats.

# The Grand 1894 Opera House

## General Information

### **Wardrobe:**

Washing machine – 4 Quarters

Dryer – 4 Quarters

Irons, ironing boards, steamers, and sewing machines are available.

All dressing room areas are equipped with air conditioning and heat, fluorescent, as well as incandescent lighting with dimming capabilities, full-length mirrors, make up counters, clothing racks and trash receptacles.

### **Dressing Rooms:**

All dressing rooms have access to restrooms and showers. All dressing rooms have running water except Dressing Room #5.

Dressing Room #1 – Star Dressing Room – Private restroom, shower and makeup counter with running water sink; wet bar with ice machine, microwave, coffee maker and a private sitting area.

Located on stage level outside stage entrance.

Dressing Room #2 – Under stage – 6 people

Dressing Room #3 – Under stage – 4 people

Dressing Room #4 – Under stage – 6 people

Dressing Room #5 – Under stage – 12 people

Dressing Room #6 – Above loading dock and shop area – 20 People

### **Communications:**

Backstage paging system that addresses all dressing areas, shop, loading dock and business office.

On stage monitoring system that broadcasts performances backstage.

Clear Com with 10 potential stations for technical communication. Included are 6 permanent stations in the following departments: stage manager, sound booth, lighting console, fly rail, 2 spots and main curtain.

Walkie-talkies are available but not recommended due to marine traffic in the area.

Internet (wireless capabilities), photo copier, fax machine, computers, printers and telephones available.

Antenna broadcast television (Houston stations), closed circuit television and satellite television.

The House Crew has cellular phones.

### **Curtains:**

Line set \* -Painted (Staley) Curtain – fly only/ Permanent Install

Line set 1 -Main Act Curtain (Red) – fly or travel/ Permanent Install

Both curtains are operated from stage level SL (single purchase) traveled from SR.

See page 9 for more details.

### **Security:**

Security lighting and surveillance cameras.

Magnetic lock on stage door with remote release, video camera on door and squawk box for communication.

The Grand contracts security officers from The Galveston Police Dept. for all performances.

# The Grand 1894 Opera House

*Electric Department*  
*Rusty Wheeler*  
*Head/House Electrician*  
*IATSE # 51*

## **Electrical Service:**

Location: Stage right wall

3 – 208 volt, 400 amp, 3 phase disconnects.

(1 is an isolated ground designated for sound use only)

## **Stage Dimming:**

Location: Loft over Stage Right wing (22'6" over deck)

2 Full Strand Century CD 80 Racks/ Johnson Systems Inc. digital upgrade

192 - Strand Century CD 80 2.4K (D/D)

6 - Strand Century CD 80 2.4K (4;D/N – 2;N/D)

## **Control:**

Location: Grand Tier enclosed booth (House right)

ETC Expression 3 lighting console 2 - 15" monitors

## **Circuiting:**

See attached provisions

## **House Lighting Control System:**

ETC Unison

Strand Century CD Dimmers

Johnson Systems Inc. digital upgrade

Master Programming Control Panel – Down Stage Right (Stage Manager)

#1 Control Panel - Lighting console booth (Board Operator)

#2 Control Panel – Orchestra Level Lobby (House Manager)

## **Notes:**

Any traveling attractions that use a stand-alone electronic dimming and control systems are encouraged to place lighting console behind Orchestra Level seating area (see attached Seating Plot) 150' from recommended placement of dimming rack Stage Right wing; next to 400 amp 3 phase electrical disconnect service.

Interface with stage dimming is available to any traveling attraction that does not travel with stand-alone dimming systems.

Linking House Light Dimming and Stage Dimming is possible.

## **Follow Spots**

4 – Strong Xenon Super troopers (1600 watt)

Location: Grand Tier Spot Booth (center house; up) Grand Tier Spot Booth (center house; down)

70° - 40° throw, up, to 65° - 35° throw, down. See attached provisions for more detailed information.

# The Grand 1894 Opera House

Electric Department  
Rusty Wheeler  
Head/House Electrician  
IATSE # 51

**Par 64:**

92 – 1000 watt standard (W, M, N & VN)

8 – 1000 watt ACL

**Altman Fresnels:**

16 – 8” 1000 watt

4 - 6” 1000 watt

**Altman:** 575 watt

39 – 6x9

72 – 6x12

30 – 6x16

**ETC Source 4**

7 - 10° 4 - 36°

16 - 19°

8 - 26°

**Strand Century 575 watt**

32 – 6” 14°

4 – 8” 10°

**Altman Scoops:**

12 – 14” 1000 watt

**Altman Strips:**

4 - 6’ 1000 watt 8 cell / 4 color (2 cells per color) Cyc

6 – 6’ 300 watt 12 cell / 4 color (3 cells per color) Ground

8 Boom bases

Various lengths of boom pipe, cheeseboroughs, side arms and crosspipe (specify)

**Side light:**

8 – ladders

6 – towers

**City Theatrical Strobe Lights:**

2 – 1000 watt / 220 volt DMX controlled

**Fog Machines:**

2 – City Theatrical Aqua Fog Machines, Dimmer controlled fans / Non dim controlled heaters

1 – City Theatrical Smoke Machine

Rosco Mirror Ball 24” with Motorized Rotation

Rosco, Lee and Gam gel inventory (upon request)

GOBO / Pattern inventory (upon request)

Inventory of frames, gobo holders, donuts, top hats and barn doors

Inventory of turn around, stingers, 2-fers, hot patch whips and misc. adaptors

Inventory of music stand lights and all necessary electrical patch cords

Inventory of various footage stagepin to stagepin patch cables

# The Grand 1894 Opera House

## Sound Department

Jim Hallene

## Head/House Sound

IATSE # 51

### **Electrical Service:**

Location: Stage right wall

3 – 208 volt, 400 amp, 3 phase disconnects.

(1 is an isolated ground designated for sound use only)

### **Mixing Console:**

Location: Mezzanine open booth (House center)

Mackie 32 channels (Main mix, 4 Sub mixes, 2 On-stage auxiliary sends)

22 Microphone channels (1>8 SR) – (9>22 SL)

1 – Yamaha Rev 500 on auxiliary 6

Any traveling attractions that use a stand-alone P.A. system are encouraged to place mixing console behind Orchestra Level seating area (see attached Seating Plot) 150' from Stage Right wing; 208 volt, 400 amp, 3 phase electrical disconnect service with an isolated ground.

### **House P.A.:**

Location: SL and SR of Proscenium

JBL Vertec 932 Line Array.

Bi-amplified and real time analyzed through a Nexia FOH processor.

SR and SL ceiling speakers:

2 – EV ZX1-90

The Grand does not have a cluster because of nonexistent rigging points in the house. Therefore, no traveling attraction or rental will be given permission to hang a cluster.

Any traveling attractions that use a stand-alone P.A. system are encouraged to place the speakers on SL and SR lip, onstage of proscenium.

### **Amplification:**

3 – Crown Xti 4000 (1200 watts @ 4 ohms) Mains

2 – QSC PLX 2402 (700 watts @ 4 ohms) Monitors

2 – QSC MX 2000a (450 watts @ 4ohms) Ceilings

### **Sound Processing:**

Nexia-FOH Processor/ complete crossover / parametric EQ / Graphic EQ / Alignment delay / compressor limiter.

# The Grand 1894 Opera House

Sound Department

Jim Hallene

Head/House Sound

IATSE # 51

## **Stage Monitor System: (Mobile P.A. System)**

Location: SR only

Makcie 24 channel (6 mixes)

16 inputs.

3 – QSC RMX 1450 Amplifiers (400 watts @ 4 ohms)

3 – Rane stereo 1/3 octave equalizers

4 – JBL MR Series Monitors

2 – JBL 4612B Monitors

2 – JBL 46120K Monitors

2 – Peavy uprights

## **Microphones:**

8 – Shure ULX Series hand held and lavalier wireless mics

5 – Shure SM58

5 – Shure SM57

2 – AT 4033a condenser mic

2 – AT 3031 condenser mic

4 – AT 871 boundary mic

1 – PZM 180 boundary mic

## **Playback:**

Tascam CD

Denon 4500 Dual CD

Denon M2300R mini disc.

Denon 720R Cassette

Technics 1-RS-1506US Reel to Reel

## **Miscellaneous:**

4 – direct boxes, stands, booms, cords and cable.

**Far Cove**

U#	Purpose	Type & Accessories	W	Color	Template	Dim	Chn
1	Special	Strand 8" 12°	1kw	N/C		1/182	
2	Area 4	Strand 6" 14°	1kw	R305		1/179	(4)
3	Area 3	Strand 6" 14°	1kw	R305		1/176	(3)
4	Area 4	Strand 6" 14°	1kw	R53		1/183	(12)
5	Special	ETC Source 4 10°	575w	N/C		1/181	
6	Area 2	Strand 6" 14°	1kw	R305		1/160	(2)
7	Area 3	Strand 6" 14°	1kw	R53		1/180	(11)
8	Area 1	Strand 6" 14°	1kw	R305		1/158	(1)
9	Special	ETC Source 4 10°	575w	N/C		1/178	
10	Area 4	Strand 6" 14°	1kw	R305		1/179	(4)
11	Area 2	Strand 6" 14°	1kw	R53		1/177	(10)
12	Area 3	Strand 6" 14°	1kw	R305		1/176	(3)
13	Special	ETC Source 4 10°	575w	N/C		1/175	
14	Special	Strand 8" 12°	1kw	N/C		1/162	
15	Area 1	Strand 6" 14°	1kw	R53		1/161	(9)
16	Area 2	Strand 6" 14°	1kw	R305		1/160	(2)
17	Area 1	Strand 6" 14°	1kw	R305		1/158	(1)

**Near Cove**

U#	Purpose	Type & Accessories	W	Color	Template	Dim	Chn
1	Special	Strand 8" 12°	1kw	N/C		1/166	
2	Area 8	Strand 6" 14°	1kw	R305		1/155	(8)
3	Area 7	Strand 6" 14°	1kw	R305		1/168	(7)
4	Special	ETC Source 4 10°	575w	N/C		1/169	
5	Area 8	Strand 6" 14°	1kw	R53		1/171	(16)
6	Special	ETC Source 4 10°	575w	N/C		1/174	
7	Area 6	Strand 6" 14°	1kw	R305		1/173	(6)
8	Area 7	Strand 6" 14°	1kw	R53		1/172	(15)
9	Area 5	Strand 6" 14°	1kw	R305		1/159	(5)
10	Special	ETC Source 4 10°	575w	N/C		1/170	
11	Area 8	Strand 6" 14°	1kw	R305		1/155	(8)
12	Area 6	Strand 6" 14°	1kw	R53		1/153	(14)
13	Area 7	Strand 6" 14°	1kw	R305		1/152	(7)
14	Special	ETC Source 4 10°	575w	N/C		1/151	
15	Area 5	Strand 6" 14°	1kw	R53		1/154	(13)
16	Area 6	Strand 6" 14°	1kw	R305		1/156	(6)
17	Special	Strand 8" 12°	1kw	N/C		1/157	
18	Area 5	Strand 6" 14°	1kw	R305		1/159	(5)

**SL Booth**

U#	Purpose	Type & Accessories	W	Color	Template	Dim	Chn
1	Amber Wash	ETC Source 4 19°	575w	G320		1/146	(18)
2	Amber Wash	ETC Source 4 19°	575w	G320		1/146	(18)
3	Amber Wash	ETC Source 4 19°	575w	G320		1/149	(18)
4	Amber Wash	ETC Source 4 19°	575w	G320		1/149	(18)

**SR Booth**

U#	Purpose	Type & Accessories	W	Color	Template	Dim	Chn
1	Blue Wash	ETC Source 4 19°	575w	G845		1/148	(19)
2	Blue Wash	ETC Source 4 19°	575w	G845		1/148	(19)
3	Blue Wash	ETC Source 4 19°	575w	G845		1/150	(19)
4	Blue Wash	ETC Source 4 19°	575w	G845		1/150	(19)

**SL Mid House**

U#	Purpose	Type & Accessories	W	Color	Template	Dim	Chn
1	Lav. Wash	ETC Source 4 19°	575w	G101		1/142	(20)
2	Blue Wash	ETC Source 4 19°	575w	G810		1/144	(21)
3	Lav. Wash	ETC Source 4 19°	575w	G101		1/142	(20)
4	Blue Wash	ETC Source 4 19°	575w	G810		1/144	(21)

**SR Mid House**

U#	Purpose	Type & Accessories	W	Color	Template	Dim	Chn
1	Pink Wash	ETC Source 4 19°	575w	G104		1/163	(22)
2	Blue Wash	ETC Source 4 19°	575w	G790		1/165	(23)
3	Pink Wash	ETC Source 4 19°	575w	G104		1/163	(22)
4	Blue Wash	ETC Source 4 19°	575w	G790		1/165	(23)

**SL Torm**

U#	Purpose	Type & Accessories	W	Color	Template	Dim	Chn
1	DSC Lav	Altman 6x12	575w	G101		1/140	(24)
2	DSC Blue	Altman 6x12	575w	G810		1/143	(25)
3	DSC Lav	Altman 6x12	575w	G101		1/140	(24)
4	DSC Blue	Altman 6x12	575w	G810		1/143	(25)
5	DSC Lav	Altman 6x12	575w	G101		1/141	(24)
6	DSC Blue	Altman 6x12	575w	G810		1/139	(25)

**SR Torm**

U#	Purpose	Type & Accessories	W	Color	Template	Dim	Chn
1	DSC Pink	Altman 6x12	575w	G104		1/138	(26)
2	DSC Blue	Altman 6x12	575w	G790		1/136	(27)
3	DSC Pink	Altman 6x12	575w	G104		1/138	(26)
4	DSC Blue	Altman 6x12	575w	G790		1/136	(27)
5	DSC Pink	Altman 6x12	575w	G104		1/137	(26)
6	DSC Blue	Altman 6x12	575w	G790		1/135	(27)

**NO. 1 ELEC.**

U#	Purpose	Type & Accessories	W	Color	Template	Dim	Chn
1	SL High Side	Par 64 WFL	1kw	G245		1/69	(52)
2	SL High Side	Par 64 WFL	1kw	G245		1/69	(52)
3	Special	Altman 6x12	1kw	N/C		1/1	
4	Pink Down	Par 64 WFL	1kw	G220		1/2	(71)
5	Blue Down	Par 64 WFL	1kw	R80		1/37	(58)
6	Amber Down	Par 64 WFL	1kw	G343		1/25	(61)
7	Special	Altman 6x12	1kw	N/C		1/3	
8	Special	ETC Source 4 36°	1kw	N/C		1/4	
9	Blue Down	Par 64 WFL	1kw	R80		1/38	(58)
10	Pink Down	Par 64 WFL	1kw	G220		1/5	(71)
11	Amber Down	Par 64 WFL	1kw	G343		1/26	(61)
12	Special	ETC Source 4 36°	1kw	N/C		1/6	
13	Blue Down	Par 64 WFL	1kw	R80		1/7	(58)
14	Special	ETC Source 4 36°	1kw	N/C		1/8	
15	Amber Down	Par 64 WFL	1kw	G343		1/27	(61)
16	Pink Down	Par 64 WFL	1kw	G220		1/9	(71)
17	Blue Down	Par 64 WFL	1kw	R80		1/39	(58)
18	Special	ETC Source 4 36°	1kw	N/C		1/10	
19	Special	Altman 6x12	1kw	N/C		1/11	
20	Amber Down	Par 64 WFL	1kw	G343		1/28	(61)
21	Blue Down	Par 64 WFL	1kw	R80		1/40	(58)
22	Pink Down	Par 64 WFL	1kw	G220		1/12	(71)
23	Special	Altman 6x12	1kw	N/C		1/13	
25	SR High Side	Par 64 WFL	1kw	G245		1/70	(55)
26	SR High Side	Par 64 WFL	1kw	G245		1/70	(55)

**NO. 2 ELEC.**

U#	Purpose	Type & Accessories	W	Color	Template	Dim	Chn
1	SL High Side	Par 64 WFL	1kw	G245		1/71	(53)
2	SL High Side	Par 64 WFL	1kw	G245		1/71	(53)
3	Special	ETC Source 4 26°	1kw	N/C		1/15	
4	Pink Down	Par 64 WFL	1kw	G220		1/77	(72)
5	Blue Down	Par 64 WFL	1kw	R80		1/41	(59)
6	Amber Down	Par 64 WFL	1kw	G343		1/29	(62)
7	Special	ETC Source 4 26°	1kw	N/C		1/16	
8	Blue Down	Par 64 WFL	1kw	R80		1/42	(59)
9	Pink Down	Par 64 WFL	1kw	G220		1/77	(72)
10	Amber Down	Par 64 WFL	1kw	G343		1/30	(62)
11	Blue Down	Par 64 WFL	1kw	R80		1/42	(59)
12	Amber Down	Par 64 WFL	1kw	G343		1/31	(62)
13	Pink Down	Par 64 WFL	1kw	G220		1/78	(72)
14	Blue Down	Par 64 WFL	1kw	R80		1/43	(59)
15	Special	ETC Source 4 26°	1kw	N/C		1/17	
16	Amber Down	Par 64 WFL	1kw	G343		1/32	(62)
17	Blue Down	Par 64 WFL	1kw	R80		1/44	(59)
18	Pink Down	Par 64 WFL	1kw	G220		1/78	(72)
19	Special	ETC Source 4 26°	1kw	N/C		1/18	
20	SR High Side	Par 64 WFL	1kw	G245		1/72	(56)
21	SR High Side	Par 64 WFL	1kw	G245		1/72	(56)

**NO. 3 ELEC.**

U#	Purpose	Type & Accessories	W	Color	Template	Dim	Chn
1	SL High Side	Par 64 WFL	1kw	G245		1/73	(54)
2	SL High Side	Par 64 WFL	1kw	G245		1/73	(54)
3	Special	ETC Source 4 26°	1kw	N/C		1/19	
4	Pink Down	Par 64 WFL	1kw	G220		1/79	(73)
5	Blue Down	Par 64 WFL	1kw	R80		1/45	(60)
6	Amber Down	Par 64 WFL	1kw	G343		1/33	(63)
7	Special	ETC Source 4 26°	1kw	N/C		1/20	
8	Blue Down	Par 64 WFL	1kw	R80		1/46	(60)
9	Pink Down	Par 64 WFL	1kw	G220		1/79	(73)
10	Amber Down	Par 64 WFL	1kw	G343		1/34	(63)
11	Blue Down	Par 64 WFL	1kw	R80		1/46	(60)
12	Amber Down	Par 64 WFL	1kw	G343		1/35	(63)
13	Pink Down	Par 64 WFL	1kw	G220		1/80	(73)
14	Blue Down	Par 64 WFL	1kw	R80		1/47	(60)
15	Special	ETC Source 4 26°	1kw	N/C		1/21	
16	Amber Down	Par 64 WFL	1kw	G343		1/36	(63)
17	Blue Down	Par 64 WFL	1kw	R80		1/48	(60)
18	Pink Down	Par 64 WFL	1kw	G220		1/80	(73)
19	Special	ETC Source 4 26°	1kw	N/C		1/22	
20	SR High Side	Par 64 WFL	1kw	G245		1/74	(57)
21	SR High Side	Par 64 WFL	1kw	G245		1/74	(57)

**NO. 4 ELEC.**

U#	Purpose	Type & Accessories	W	Color	Template	Dim	Chn
1	Cyc Blue	2 Cell 4 Color Strips	1kw	R125		1/89	(64)
1	Cyc Amber	2 Cell 4 Color Strips	1kw	R127		1/93	(68)
1	Cyc Red	2 Cell 4 Color Strips	1kw	R124		1/82	(66)
1	Cyc Green	2 Cell 4 Color Strips	1kw	R126		1/85	(70)
2	Pink Down	Par 64 WFL	1kw	G220		1/76	(74)
3	Cyc Amber	2 Cell 4 Color Strips	1kw	R127		1/94	(68)
3	Cyc Green	2 Cell 4 Color Strips	1kw	R126		1/86	(70)
3	Cyc Blue	2 Cell 4 Color Strips	1kw	R125		1/90	(64)
3	Cyc Red	2 Cell 4 Color Strips	1kw	R124		1/81	(66)
4	Pink Down	Par 64 WFL	1kw	G220		1/75	(74)
5	Cyc Amber	2 Cell 4 Color Strips	1kw	R127		1/95	(68)
5	Cyc Red	2 Cell 4 Color Strips	1kw	R124		1/83	(66)
5	Cyc Blue	2 Cell 4 Color Strips	1kw	R125		1/91	(64)
5	Cyc Green	2 Cell 4 Color Strips	1kw	R126		1/87	(70)
6	Pink Down	Par 64 WFL	1kw	G220		1/75	(74)
7	Cyc Blue	2 Cell 4 Color Strips	1kw	R125		1/92	(64)
7	Cyc Green	2 Cell 4 Color Strips	1kw	R126		1/88	(70)
7	Cyc Amber	2 Cell 4 Color Strips	1kw	R127		1/96	(68)
7	Cyc Red	2 Cell 4 Color Strips	1kw	R124		1/84	(66)

## Standard House Plot The Grand 1894 Opera House

CHANNEL	DIMMER	FUNCTION	COLOR	CHANNEL	DIMMER	FUNCTION	COLOR
1	158	Area 1 - Warm	G106	39			
2	160	Area 2 - Warm	G106	40			
3	176	Area 3 - Warm	G106	41			
4	179	Area 4 - Warm	G106	42			
5	159	Area 5 - Warm	G106	43			
6	156,173	Area 6 - Warm	G106	44			
7	152,168	Area 7 - Warm	G106	45			
8	155	Area 8 - Warm	G106	46			
9	161	Area 1 - Cool	G820	47			
10	177	Area 2 - Cool	G820	48			
11	180	Area 3 - Cool	G820	49			
12	183	Area 4 - Cool	G820	50			
13	154	Area 5 - Cool	G820	51			
14	153	Area 6 - Cool	G820	52	70	1R High Side Red	G245
15	172	Area 7 - Cool	G820	53	72	2R High Side Red	G245
16	171	Area 8 - Cool	G820	54	74	3R High Side Red	G245
					69	1L High Side Red	G245
18	146,149	Amber Wash	G320	56	71	2L High Side Red	G245
19	148,150	Dark Blue Wash	G845	57	73	3L High Side Red	G245
20	142,145	Pink House Left	G135	58	7,37>40	1E Blue Down	G890
21	144,147	Light Blue House Left	G790	59	41>44	2E Blue Down	G890
22	163,167	Pink House Right	G135	60	45>48	3E Blue Down	G890
23	164,165	Light Blue House Right	G790	61	25>28	1E Amber Down	G343
24	139,143	Pink Torm Left	G104	62	29>32	2E Amber Down	G343
25	140,141	Light Blue Torm Left	G842	63	33>36	3E Amber Down	G343
26	135,136	Pink Torm Right	G104	64	89>92	BLUE CYC	R121
27	137,138	Light Blue Torm Right	G842	65			
28				66	81>84	RED CYC	R120
29				67			
30				68	93>96	AMBER CYC	R123
31				69			
32				70	85>88	GREEN CYC	R122
33				71	2,5,9,12	1E Pink Down	G220
34				72	77,78	2E Pink Down	G220
35				73	79,80	3E Pink Down	G220
36				74	75,76	4E Pink Down	G220
37				75			
38				76			

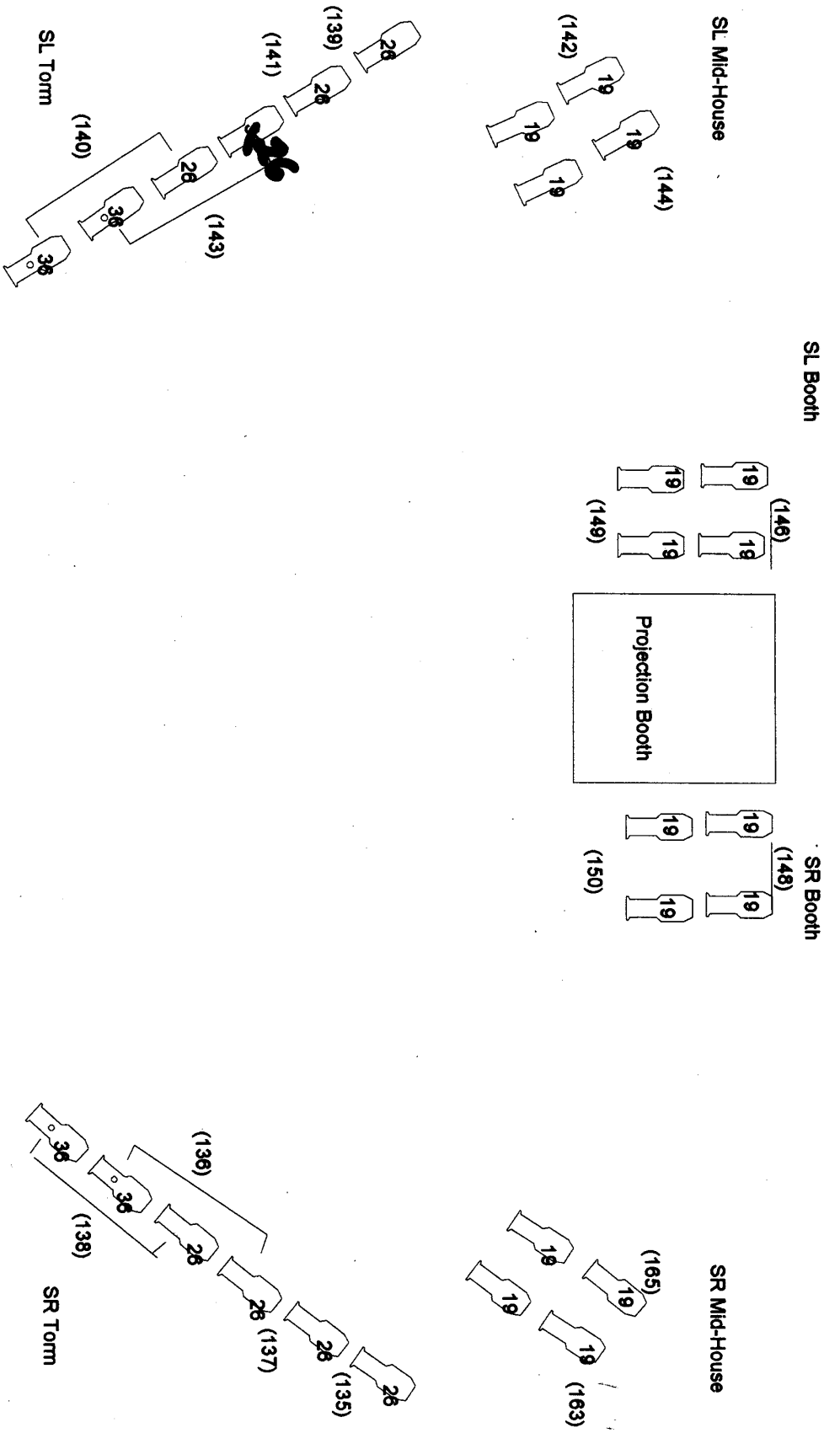

ETC Sourced Instruments

(Dimmer Number)

s4-19      s4-26      s4-36

**The Grand 1894 Opera House**

**Torm, Mid-House and Booth Positions**

Prepared by: Jeffrey M. Pye

**NOT TO SCALE**

Lighting Plan

Dir: \_\_\_\_\_ Sheet: \_\_\_\_\_

Dsgnr: lides\jmes\toh1.ldp Scale: 1/4 in = 1 ft

DR By: \_\_\_\_\_ Date: 8/30/02



Updated Sept. 2002

S.L.

FAR COVE Distance to Proscenium - 64'-6"

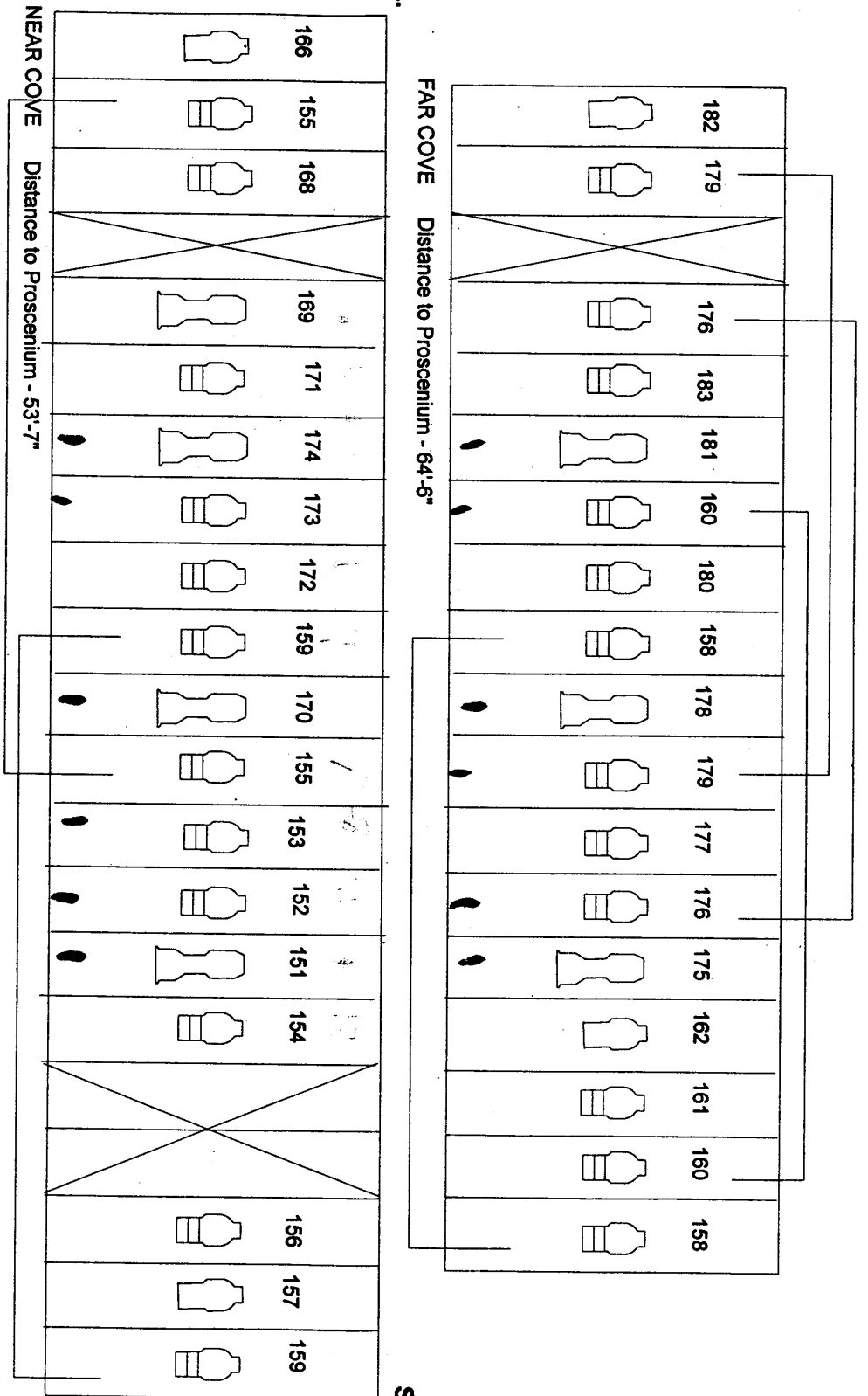
S.R.

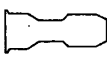
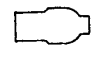

Dimmer #	Dimmer #	Dimmer #
		
Source 4 10 Degree	Strand 8" 12 Degree	Strand 6" 14 Degree

**The Grand 1894 Opera House**  
**Front of House Cove Positions**  
**NOT TO SCALE**  
 \\ides\files\cove2.ldp

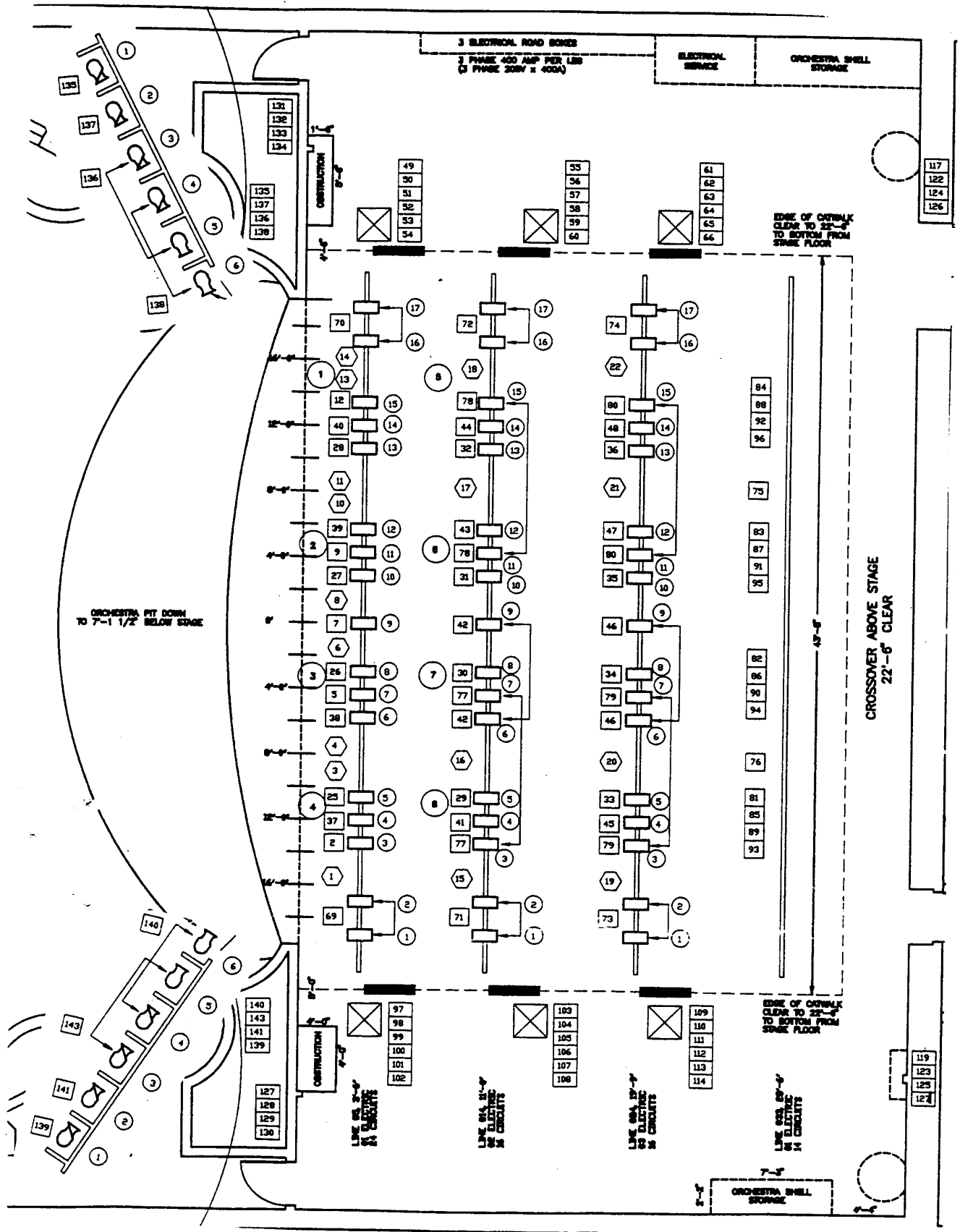

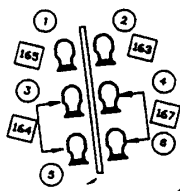
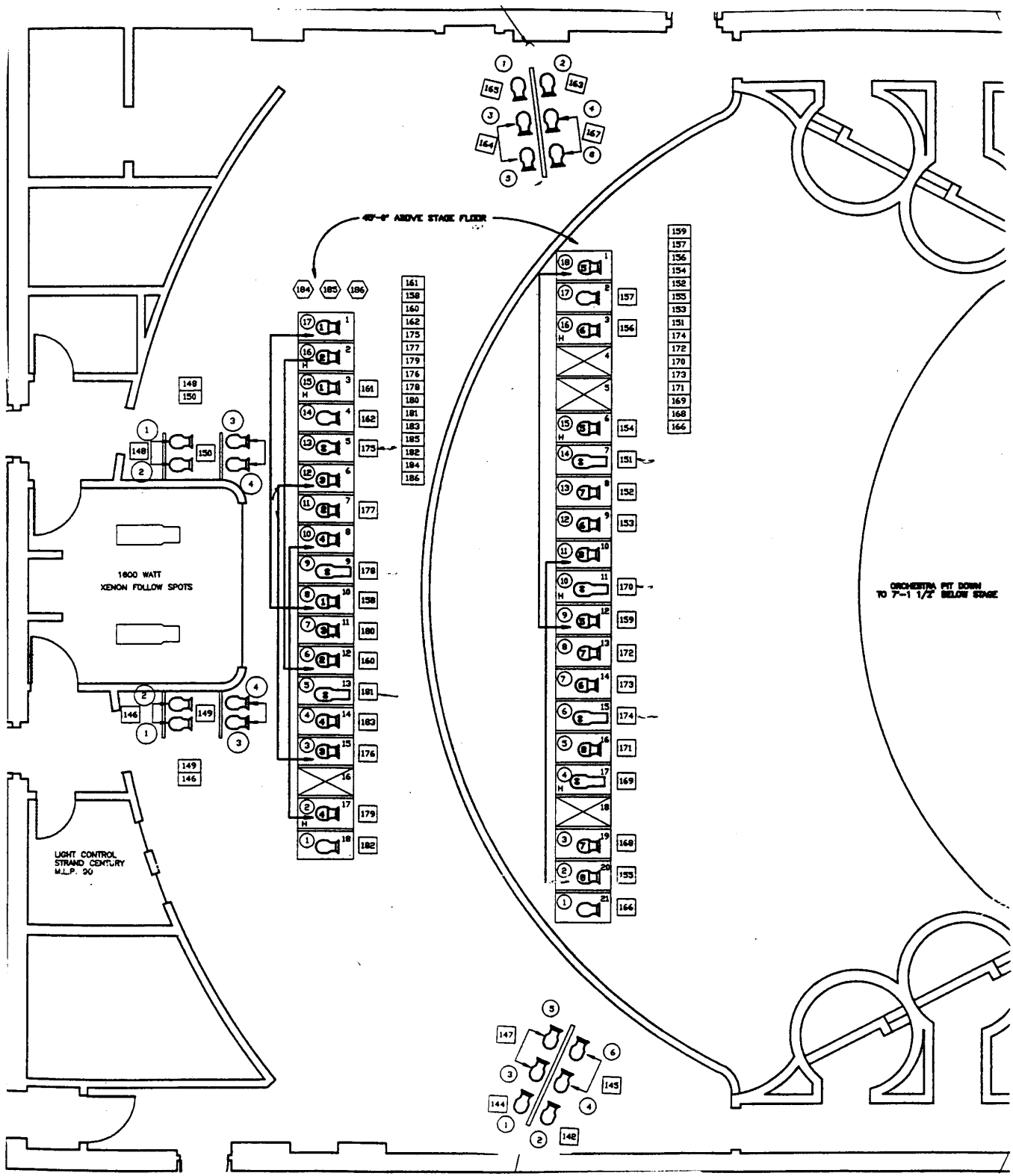

49'-0" ABOVE STAGE FLOOR

1800 WATT  
XENON FOLLOW SPOTS

LIGHT CONTROL  
STRAND CENTURY  
M.L.P. 20

ORCHESTRA PIT DOWN  
TO 7'-1 1/2" BELOW SCENE

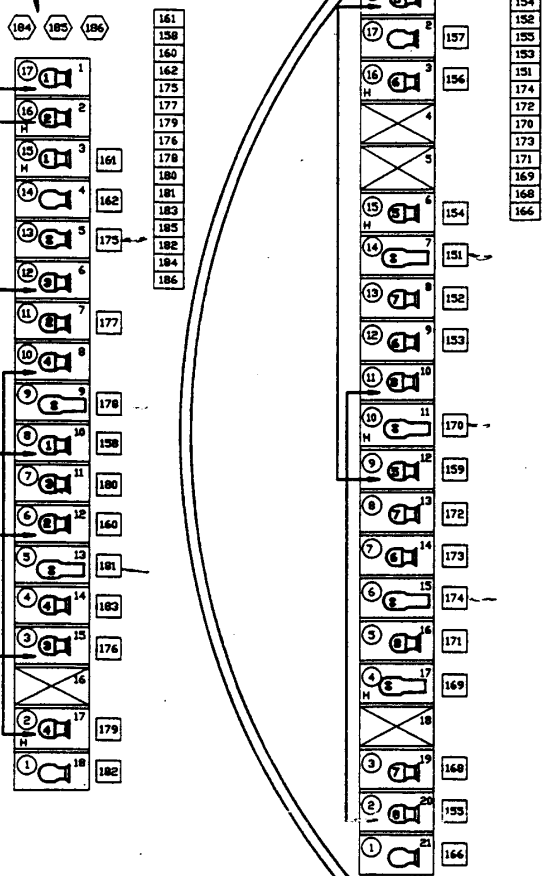
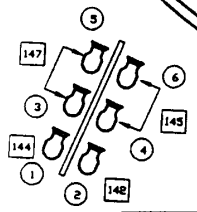

Line Set	CW/Hemp	Plaster Line Distance	House Use	Show Use
*	CW	0'-6"	Fire Curtain	
*	CW	1'-0"	Painted Curtain	
1	S	1'-4"	Grand Red Teaser	
2	CW	1'-9"	Red Act Curtain/ #1 Legs	
3	S	2'-2"	#1 Black Border	
4	CW	3'-0"		
5	CW	3'-9"	#1 Electric	
6	S	5'-6"		
7	S	6'-3"		
8	S	7'-0"		
9	S	7'-9"		
10	S	8'-3"		
11	S	9'-0"	#2 Black Border	
12	CW	9'-9"	#2 Black Legs	
13	CW	10'-3"		
14	CW	11'-0"	#2 Electric	
15	S	12'-9"		
16	S	13'-6"		
17	S	14'-3"		
18	S	15'-0"		
19	CW	15'-9"	Midstage Blackout Curtain	
20	S	16'-6"		
21	S	17'-0"		
22	S	17'-6"	#3 Black Border	
23	CW	18'-0"	#3 Black Legs	
24	CW	18'-9"		
25	CW	19'-9"	#3 Electric	
26	S	20'-6"		
27	S	21'-3"		
28	S	21'-9"		
29	S	22'-6"		
30	S	23'-0"		
31	CW	23'-6"		
32	S	25'-3"	#4 Black Border	
33	CW	25'-9"	#4 Black Legs	
34	S	26'-6"		
35	S	27'-0"		
36	CW	28'-0"	#4 Electric	
37	S	29'-6"		
38	S	30'-0"		
39	S	30'-6"		
40	CW	31'-0"		
41	CW	31'-6"	Cyc	
42	CW	32'-0"	Upstage Blackout Curtain	
			4' Crossover & Catwalk @22'	
		36'-0"	Theater Back Wall	

**Notes**  
**Pipe Battens = 42'-0"**  
**Proscenium Opening = 38'-0"**  
**Total Linesets = 26 Hempsets & 15 Available Counterweights**  
 Anything wider than 43' cannot be flown higher than 22'-6" because of elevated pin rail above wings  
 Dark line between 14-15 & 31-32 indicates an "18 wide wooden beam that supports the grid

# The Grand 1894 Opera House



## Every Need -Every Wish -Every Dream

This magnificently restored, historic 1000 seat Opera House is available for convention groups, meetings, receptions, parties or privately booked performances. Take advantage of its intimate setting -the stage, the lobbies, the meeting rooms - all available for your special event. Our staff of professionals can help you plan any event, large or small.

**LIVE PERFORMANCES** -We can schedule a special performance just for your convention or group entertainment.

**BREAKOUTS** - Over 11,000 square feet of meeting space that can be utilized for your special event.

**FOOD AND BEVERAGE** - Full catering and refreshment services can be arranged for meetings, receptions and sit-down dinners.

**CENTRAL LOCATION** - Located in the heart of the financial and Historical Downtown area and within walking distance of The Strand shopping district, hotels, the Port of Galveston and Cruise Ship Terminals.

**COMPLETE HANDICAP ACCESS** - The Grand meets all state and federal guidelines for disabled access. Several seating options are available. Sound enhancement is available for the hearing impaired.

**SAFETY FIRST** - The entire complex is completely sprinkled for your safety and includes the finest in fire and burglary alarm protection.

### **The Grand 1894 Opera House**

2020 Postoffice Street -Galveston Island, Texas 77550  
409.765.1894 /www.thegrand.com/ 800.821.1894

For further information call, email or write:

Maureen M. Patton, Executive Director  
The Grand 1894 Opera House

2020 Postoffice Street -Galveston Island, Texas 77550  
409.763.7173/ mpatton@thegrand.com

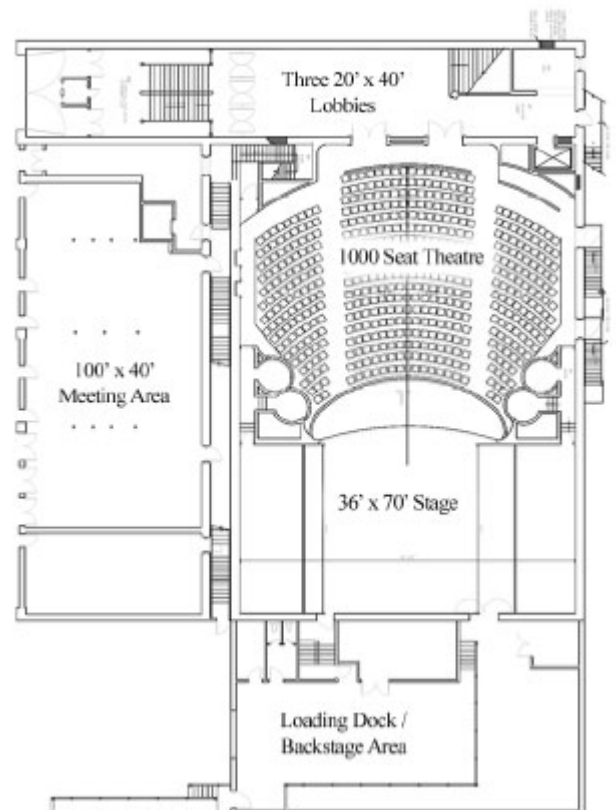

# SEATING CHARTS

## Orchestra (1<sup>st</sup> level)

Please note: RED seats are considered slightly obstructed and are offered at a reduced rate.

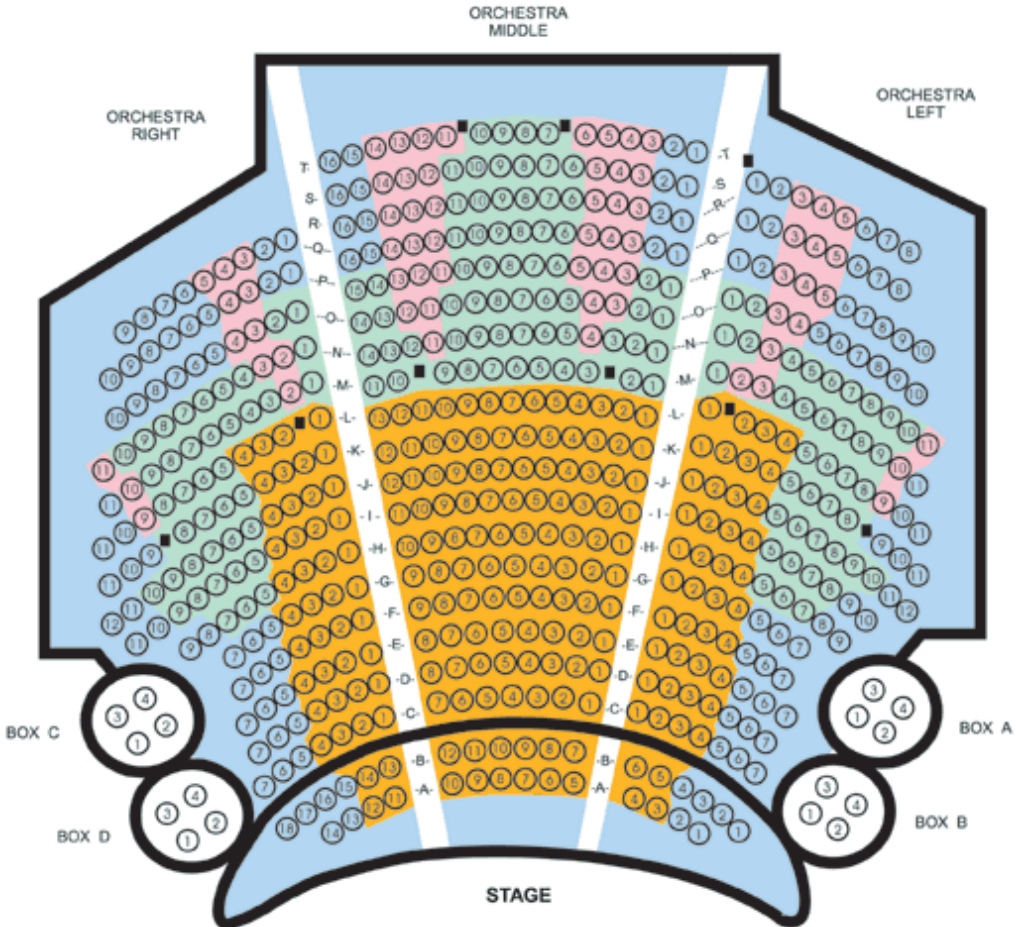

## Mezzanine (2<sup>nd</sup> level)

Please note: RED seats are considered slightly obstructed and are offered at a reduced rate.

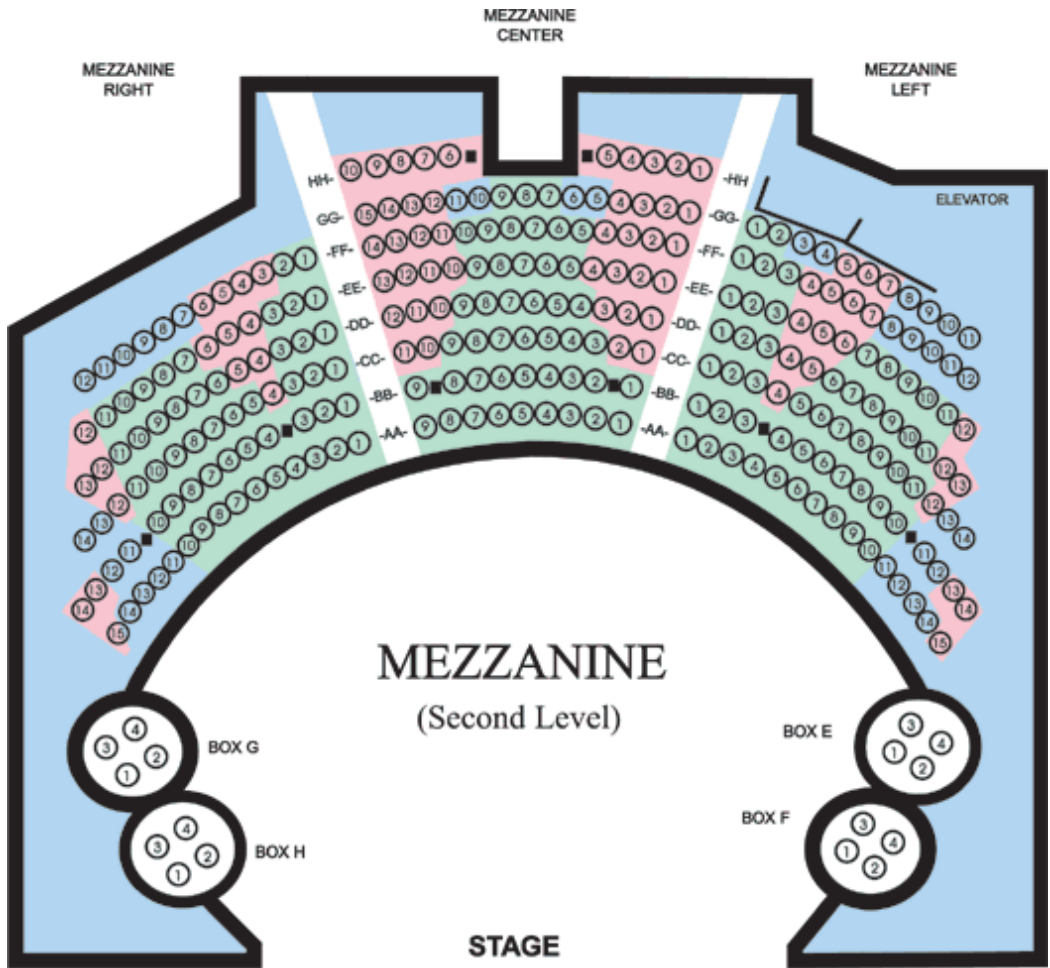

## Grand Tier (3<sup>rd</sup> level)

Please note: RED seats are considered slightly obstructed and are offered at a reduced rate.

GRAND TIER  
RIGHT

GRAND TIER  
CENTER

GRAND TIER  
LEFT

